

Plot Check

SD _____

Teak Faux

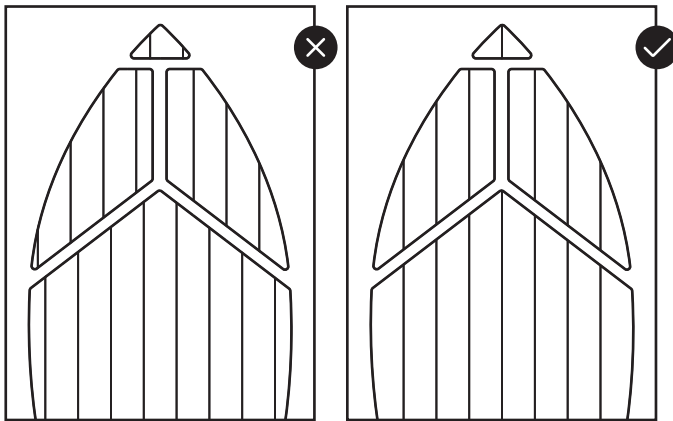

Shifted Teak Faux

Symmetrical Teak Faux

Instruction

To ensure that the teak faux is continuous and straight from bow to stern (see Figure above), the individual foils must be joined together.

Draw straight lines from foil to foil. This is how you create connection points, which we will use as a guide when drawing (see Figure 3).

To check your plot foils, please follow the instructions below. Also, please fill in the reverse side and return the form to us.

Cut out foils and leave an edge of approx. 2 cm, fix on the boat and compare (1).

- Draw in changes with a different colored pen (2), if necessary.
- Draw connecting lines on foils for positioning (3).

i The plot drawing is a few millimeters larger all around than your non-skid? No problem. This addition is intentional. This way we make sure that the SeaDek® fully covers all areas.

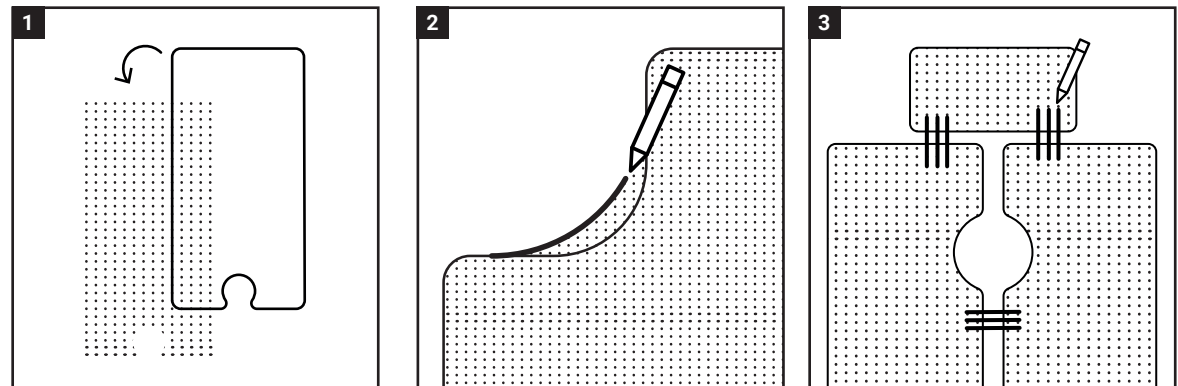

Please turn over & fill in →

Checklist

Orders can be processed only when we receive pictures of the fixed foils lying on the boat.

01

- Clean surface
- Lay out and cut foils
- Fix foils with crepe-tape
- Draw in changes if necessary
- Specify material allowance (e.g. 3 – 5 mm)
- Connect foils with symmetrical strokes

02





- Take photos of the fixed foils **on the boat**
- Send photos to seadek@seadek.de
- Clean foils and send it back to us

Done! 😊

Material details

SD _____

Pattern

-  Teak Faux
-  Pinline
-  Solid
-  Own/other

Colour

- Mocha ov Black
- Storm Gray ov Black
- Other: _____

Thickness

- 3mm plain
 - 5mm plain
 - 6mm two-tone (TF)
- Other thicknesses on request*

Look

-  Brushed
-  Nubbed

Material allowance

_____ mm (This material allowance is added to your current drawing)

Logo

- Yes
- No

*Logos and fonts
to seadek@seadek.de*

SeaDek Certified Fabricator
Otto-Wallach-Straße 12
65203 Wiesbaden
seadek@seadek.de

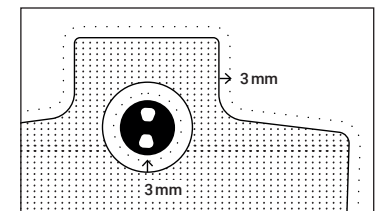

Ex. material allowance